

1
2 THRU 19

2
3 THRU 18

5
6 THRU 11

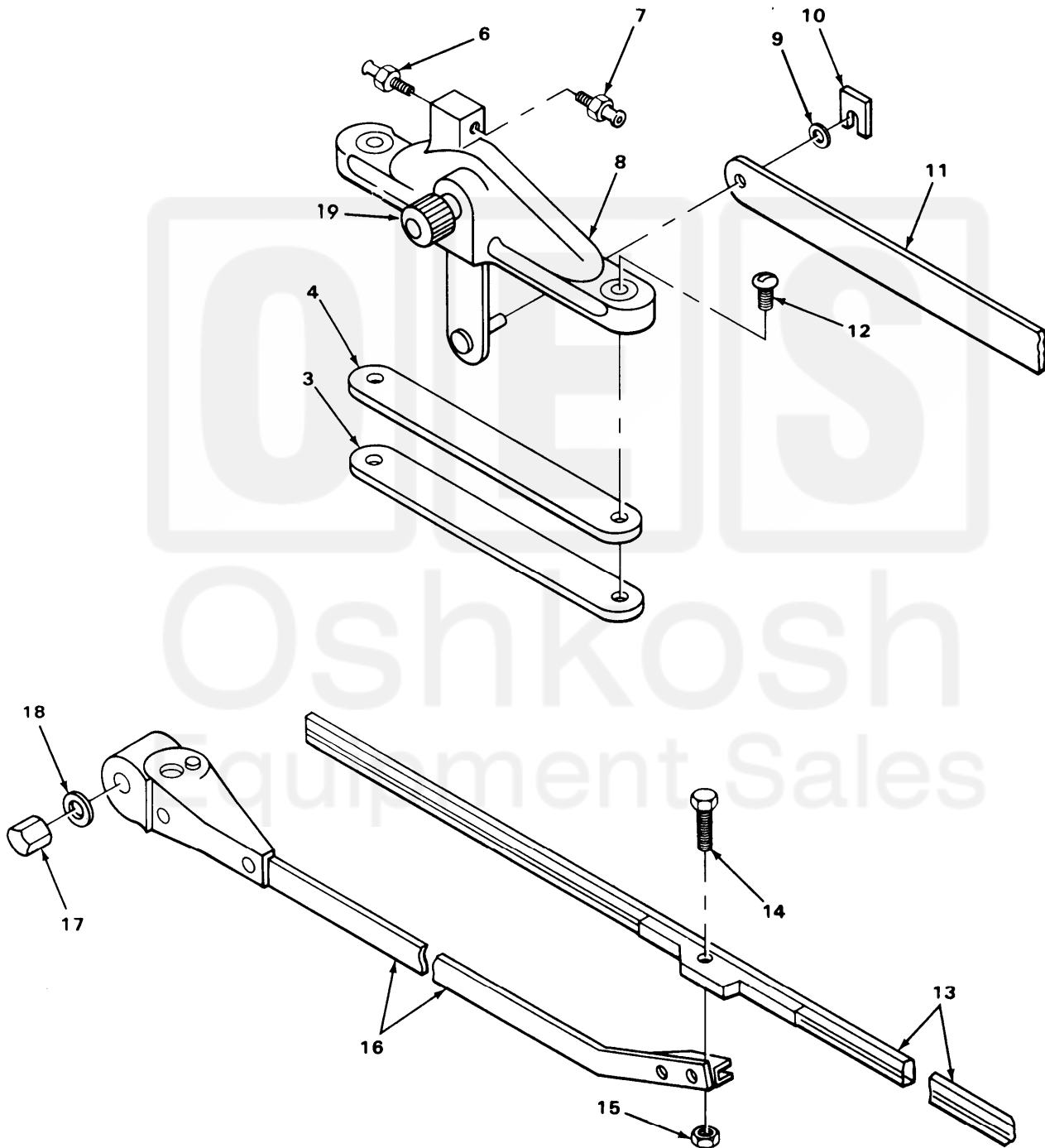

TA217210

FIGURE 279. WINDSHIELD WIPER ASSEMBLY.

Current part is item (13) on diagram. Available at www.oshkoshequipment.com

SECTION II (1)	ITEM (2)	SMR (3)	FSCM (4)	TM9-2320-273-24P PART NUMBER	(5)	DESCRIPTION AND USABLE ON CODE (UOC)	(6)	QTY
GROUP:22 CHASSIS AND HULL ACCESSORY ITEMS								
GROUP:2202 ACCESSORY ITEMS								
FIGURE 279. WINDSHIELD WIPER ASSEMBLY.								
1	PAOOO	34623	5932051			ASSY,WASHER AND WIP		1
2	PAOOO	60703	9102-13			.WINDSHIELD WIPER		2
3	PBOZZ	60703	A86448J			..SPACER,PLATE		2
4	PBOZZ	60703	86447			..GASKET		2
5	PBOOO	34623	5731520			..PIVOT BODY ASSEMBLY AND		1
5	PBOOO	60703	89142-121ZF			CONNECTING ARM LH		1
6	PAOZZ	60703	88171-4JD			..PIVOT ASSEMBLY,WIND AND		1
7	PAOZZ	60703	86022-4JD			CONNECTING ARM RH		2
8	PAOZZ	60703	86446-2BC			...NOZZLE,WINDSHIELD		2
9	PBOZZ	60703	95000-37J			UOC:U22,U23,U24,U25,U26		2
10	PAOZZ	60703	78647-1J			...ADAPTER,STRAIGHT,TU		2
11	PFOZZ	60703	89340-284			...PIVOT,BODY		2
11	PFOZZ	60703	89339-345			...WASHER,FLAT		2
12	PAOZZ	60703	86941-18JD			...CLIP,SPRING TENSION		2
13	PAOZZ	34623	88600-47E			...ARM,WINDSHIELD WIPE		1
14	PAOZZ	60703	NO.5-40X9/16			...CONNECTING LINK,RIG		1
15	PAOZZ	60703	NO.5-40			..SCREW,MACHINE		4
16	PAOZZ	60703	90981-15BC			..BLADE,WINDSHIELD WI		1
16	PAOZZ	60703	90982-15EC			..SCREW,MACHINE		2
17	PAOZZ	60703	75026-2ZF			..NUT,PLAIN,HEXAGON		2
18	PAOZZ	60703	2397-J			..ARM,WINDSHIELD WIPE LH		1
19	PAOZZ	60703	86324-13			..ARM,WINDSHIELD WIPE RH		1
						UOC:U22,U23,U24,U25,U26		2
						..NUT,PLAIN,CAP		2
						..WASHER,LOCK		2
						..BUSHING,TAPERED		1

END OF FIGURE



Current part is item (13) on diagram. Available at www.oshkoshequipment.com